

1	INTERNAL CONTROL SHAFT.
2	MAKE SURE CUTOUPS LINE UP WITH MICROSWITCHES
3	FUSE HOLDER.HOLDS 1.5 AMP FUSE 120 VAC
4	EMI FILTER
5	VARIATOR
6	MICROSWITCH S2,AUTHORIZE POWER CONTROL
7	MICROSWITCH S3,BATTERY CONNECT
8	MICROSWITCH S1,REGISTER RESET CONTROL
9	BATTERY,6 VOLT 1AMP-HOUR
10	TRANSFORMER,120 V TO 12 VAC.
11	SECURING SPONGE,BC720
12	TUB PAN,BC554
13	WIRE #7
14	WIRE #8
15	WIRE #11
16	WIRE #15
17	WIRE 3" BLACK 18GA.
18	WIRE #3
19	WIRE #1
20	WIRE #2
21	WIRE 6" WHITE 18GA.
22	WIRE 2" BLACK 18GA.
23	WIRE 2" BLACK 18GA.
24	WIRE 4" RED 20GA.
25	WIRE 4" BLACK 20GA.
26	WIRE 5" RED 20GA.
27	WIRE 4" BLUE 20GA.
28	CONNECTOR PROTECTOR CLIP
29	18GA. 3 PIN CONNECTOR
	6 PIN CONNECTOR

KRAUS INDUSTRIES LTD		MICON 200	
DESIGNED BY:		INTERNAL HEAD ASSEMBLY	
DRAWN BY: ANNETTE BAGE		DO NOT SCALE DIMENSIONS	
DATE: APRIL 17/91		SCALE: FULL	
		REV. 2	
		N° 3886	

BATTERY OFF

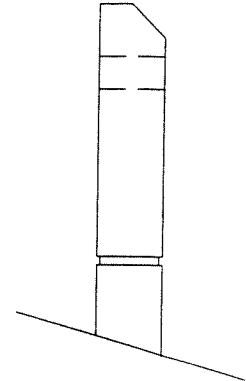

BATTERY ON

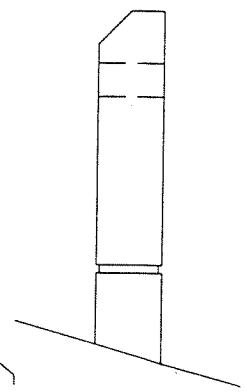

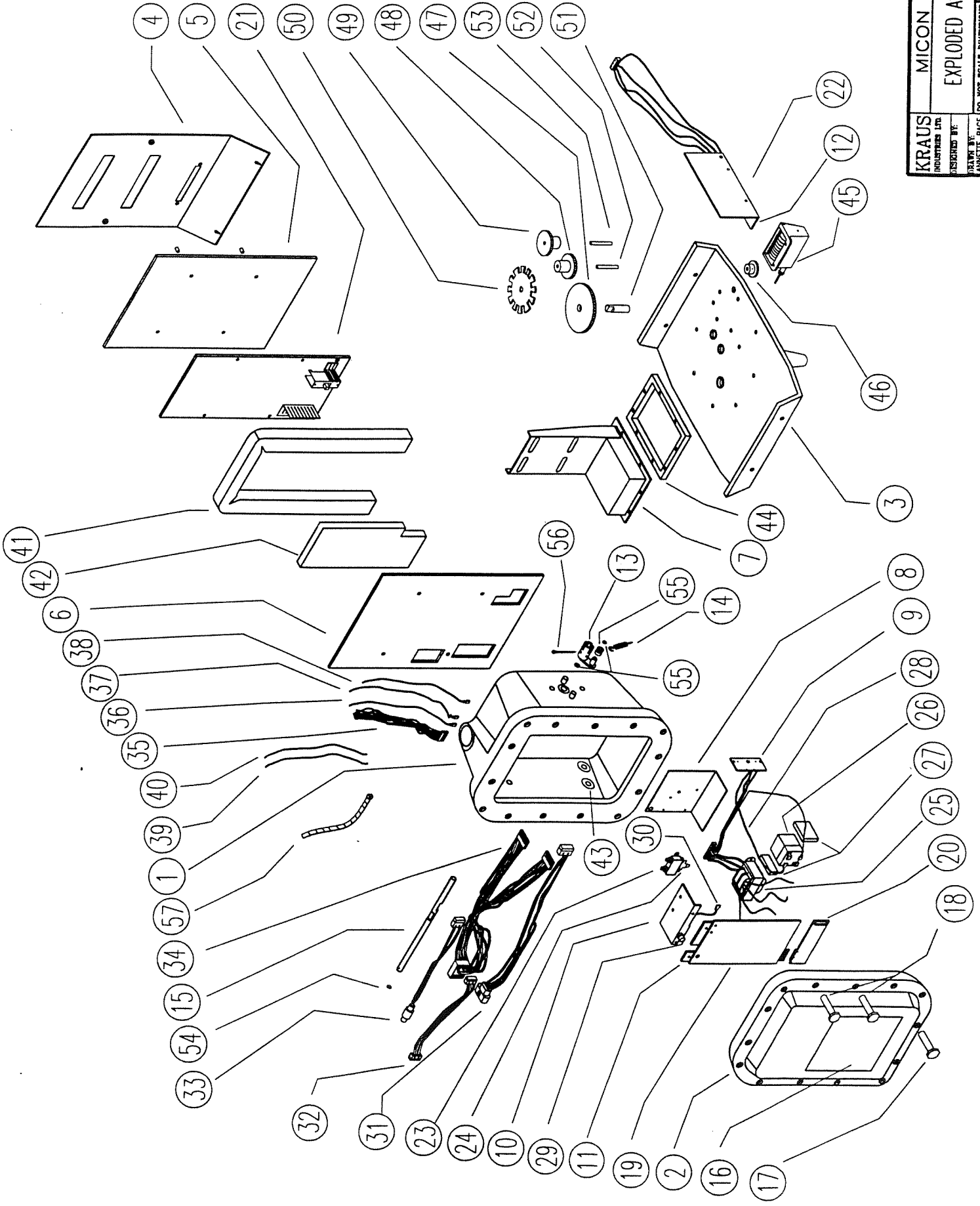

KRAUS		MICON 200	
INDUSTRIES LTD.		EXPLODED ASSEMBLY	
DESIGNED BY:	STATE	DO NOT SCALE DIMENSIONS	REV
DRAWN BY:	SCALE	PART NUMBER	N° 4185
DATE	15/73		

MICON PARTS LIST

ITEM#	DESCRIPTION	PART#
1	MAIN HOUSING	BC81
2	LID	BC83
3	BASE	BC557
4	FACEPLATE	BC11
5	DISPLAY LENS	BC429
6	DISPLAY BACKING PLATE	BC428
7	MAIN SUPPORT BRACKET	BC116
8	CHASSIS	BC554
9	SWITCH PLATE ASSEMBLY	BC32
10	MAIN HEATSINK	BC179
11	MAIN BOARD HEATSINK	BC893
12	PULSER BOARD BRACKET	BC76
13	HANDLE COUPLER	BC103
14	COUPLER SPRING	BC103S
15	HANDLE SHAFT	BC181
16	NAME PLATE	BC1007
17	LID BOLTS	
18	LID SEAL(FOR ATC TYPE ONLY)	
19	MAIN BOARD	SK252/ SK 350
20	ATC/CALIBRATION BOARD	SK291
21	DISPLAY BOARD	BC427
22	PULSER BOARD	SK246
23	EMI FILTER	
24	VARISTOR PIN	
25	12V TRANSFORMER	25A
26	6V BATTERY	1AH
27	BATTERY SPONGES	BC719
28	POSITIVE BATTERY WIRE	W116
29	FUSE HOLDER	
30	FUSE HOLDER WIRE	W115
31	PULSER HARNESS	W110
32	ATC HARNESS	W87-20I
33	PROBE HARNESS	W120
34	DISPLAY HARNESS	W109
35	CUSTOMER HARNESS	W112
36	ORANGE WIRE # 7	W117
37	BLACK WIRE # 8	W118
38	GREEN GROUND WIRE	W119
39	18 AWG TEW WIRE # 1	W67-3F/BLK
40	18 AWG TEW WIRE # 14	W67-3F/BRN
41	DISPLAY GASKET	BC426
42	DISPLAY BACKING SPONGE	
43	RUBBER PLUGS	BC190
44	PULSER COVER GASKET	BC568
45	COUNTER ASSEMBLY	
46	COUNTER BEVEL GEAR	
47	MAIN SPUR GEAR	
48	IDLER SPUR GEAR	
49	COUNTER SPUR GEAR	
50	PULSER DISK	BC182
51	MAIN SHAFT	BC241
52	IDLER/PULSER DISK SHAFT	BC241
53	COUNTER SHAFT	BC241
54	RETAINING RING	
55	COUPLER ROLLER	BC103R
56	COTTER PIN	
57	TIE WRAP	